

DO NOT SCALE

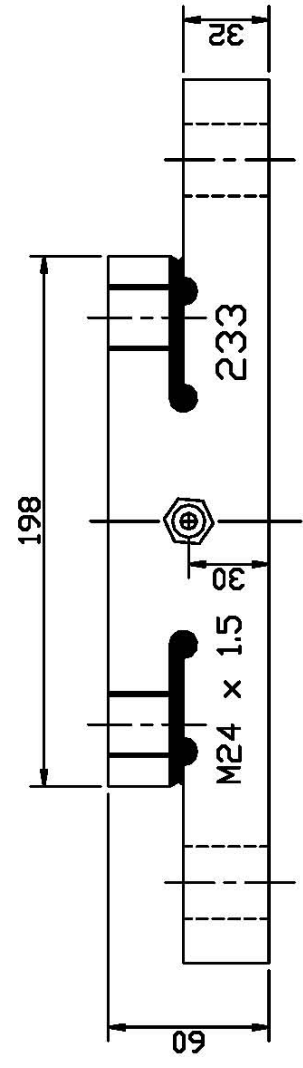

DRG. No. DL 02882

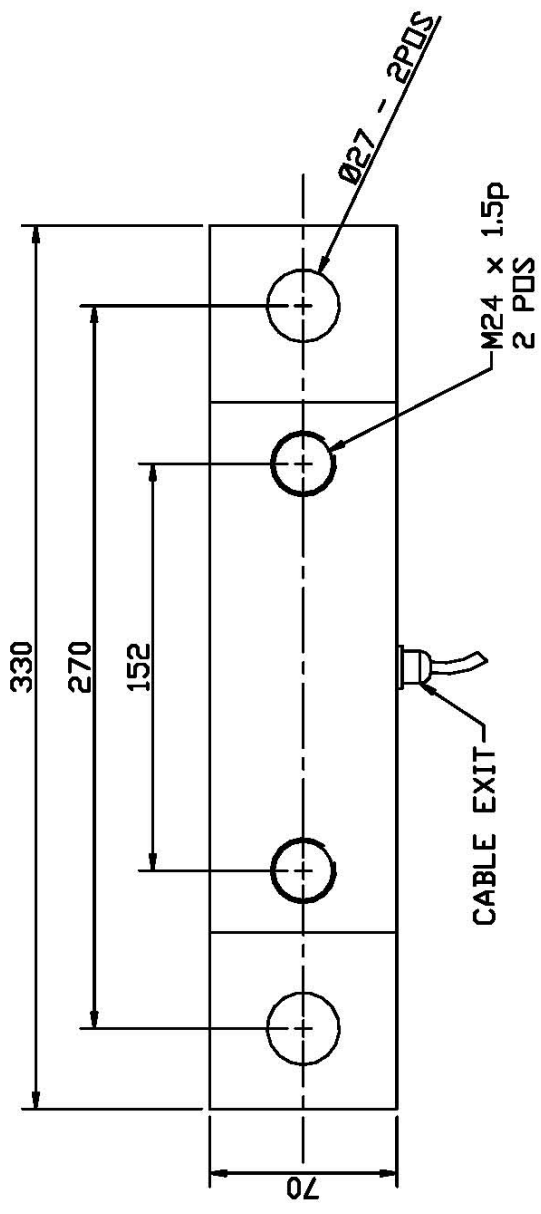

NOTES: MATERIAL - TOOL STEEL
 NICKEL PLATED
 SEALED TO IP66
 CABLE LENGTH = 10 meters
 OUTPUT = 0.5mV/V @ 5670 kg
 ACCURACY: 0.1% F.S.
 PART No: AV233/15000

NOTE:
 SECURING BOLTS MUST BE TORQUED
 TO ±5% OF 650 FT-LBS / 880 Nm

MAXIMUM OVERLOAD = 15,000 kg
 MAXIMUM LIFT OFF = 15,000 kg
 MAXIMUM SIDE FORCE = 15,000 kg

| ISS. | DATE | DCN | NOTE |
|------|------------|-----|-----------------------------|
| 6 | 24-06-2008 | 589 | CABLE EXIT MOVED UP 1mm |
| 5 | 05-04-2007 | 429 | ACCURACY ADDED |
| 4 | 06-03-2006 | 321 | NEW ENGRAVING ADDED |
| 3 | 10-02-2006 | 310 | TITLE TYPE 233 NEW TYPE 233 |
| 2 | 08-09-2003 | 236 | CABLE LENGTH & OUTPUT ADDED |
| 1 | 14-03-2001 | | |

| SCALE | UNITS | TOLERANCE | DRAWN | CHECKED | APP'D |
|----------------------|-------|-----------|-------|----------|-----------|
| NTS | MM | ±0.2 | JEMA | A. Price | J. Treacy |
| TITLE | | | | | |
| ANVIL TYPE 233 | | | | | |
| DRAWING No. DL 02882 | | | | | |
| VEHICLE LOAD CELL | | | | | |

Hense Wägetechnik GmbH
 Oststraße 18
 59929 Brilon
 www.hense-waegetechnik.de